

Cannot Backup an App by Direct Clone

ISSUE

An app doesn't be back up by Direct Clone.
An app is displayed as *Not Allowed* in Direct Clone.

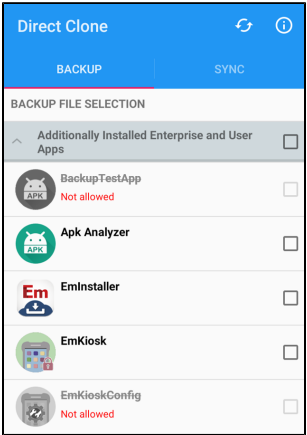

APPLIES TO

All Android models with Direct Clone

RESOLUTION

When the **allowBackup** element is set as **false** in the app's declaration, the app is not allowed to backup.

If you can access AndroidManifest.xml of the app, look at the file and change the content as below. Otherwise, contact the IT admin or the app developer.

AndroidManifest.xml

```
<application
...
                                android:allowBackup="true">
...
</application>
```

Refer to the Android Developer guide for more information.

Android Developer Guide - <application>



RELATED ARTICLES

- [Backup and Restore Wireless Network Profiles using Direct Clone](#)
- [Direct Clone](#)