

Charging RF850, RF800

There are two ways to charge RF850. This article describes those and what is the difference.

APPLIES TO

RF850

(RF800 - Only applies to charge with AC/DC adaptor)

Charge with AC/DC adaptor(USB Type-C)

Connect the AC/DC adaptor to RF850/RF800.

If the AC/DC power connected properly, the Charging LED of RFID Sled lights solid red. Refer to the below table(expand) informing the RF850/RF800 LED indicator.

RFID Sled LED Indicator

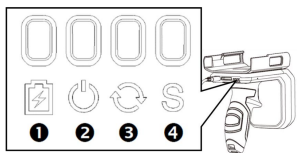

1. Charging LED	Solid Red	Battery is charging
	Solid Green	Battery is fully charged
2. Power LED	Solid Red	Power is On
	Blinking Red	Power is low
	Solid Green	BT is connected
	Blinking Green	BT is connected and power is low
	Solid Orange	USB connected to PC
	Blinking Orange	USB connected to PC and power is low
3. Mode LED	Red	BT SPP connected
	Green	BT HID connected
	Orange	Connected to BT pairing app or USB connected
4. Status LED	Red	UHF RFID ready
	Green	Barcode scan ready

If all LED indicators except charging LED blinking at the same time, it indicates the battery is too low to turn on the reader.

In this case, charge the reader enough.

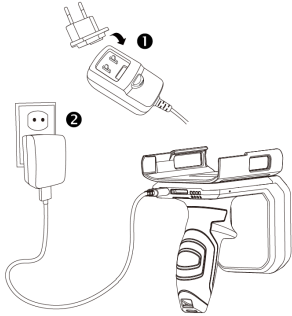

Charge with Cradle(Only RF850)

If you plugged the PM85 to RF850, you can use a cradle(optional accessory) to charge the device.

Place the device into the cradle as below image.

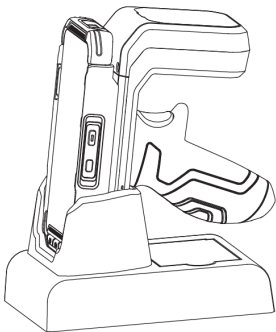

DIFFERENCE

If you use the cradle to charge, the PM85 and RF850 will charge at the same time.

But if you use USB Type-C, Only RF850(or RF800) will charge.



RELATED ARTICLES

- [RFID Sled LED Indicator](#)
- [Charging PM75/PM90 & RF750/RF900](#)
- [Embedded RFID Tag in PM550](#)
- [RFID Reader Supporting Wired Connection](#)