

Backup and Restore Wireless Network Profiles using Direct Clone

APPLIES TO

Point Mobile devices with Android 5.0.2 or above

Read Direct Clone Guide First

Read [Direct Clone](#) guide first for better understanding.

What to Backup?

(This section describes what to backup in the [Step 2 of Master Device side in the Direct Clone guide.](#))

In the master device that will be the standard, select **Settings Storage** to backup the wireless network profiles (Wi-Fi, Mobile network, ethernet, etc.) from the **BACKUP** tab of the Direct Clone.

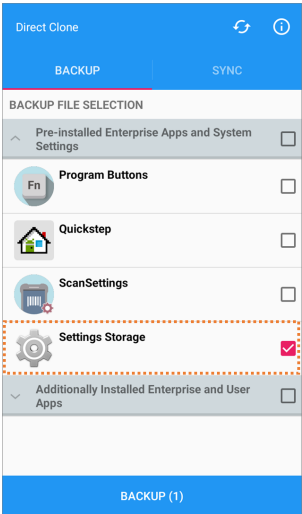

Backup coverage depends on model and SKU. For detail information, please contact Point Mobile.

How to Restore?

- From the master device, select the backup file and tap **Direct Clone** icon  in the **SYNC** tab.
- From the client devices, tap **START DIRECT CLONE SERVICE** to get the backup file and restore using it.

Refer to the [Direct Clone](#) for more detailed steps.

RELATED ARTICLES

- [Direct Clone](#)
- [Cannot Backup an App by Direct Clone](#)

